

British Standard Welded Steel Pipes

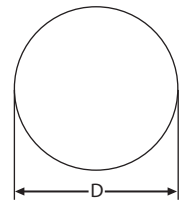

BS 1387: 1985

Thickness Class	Nominal Size		Outside Diameter	Wall Thickness	Inside Diameter	Calculated Weight				Test Pressure	
	mm	in				kg/m	kg/6m	kg/m	kg/6m	kgf/cm ²	Psi
Light "A"	15	1/2	21.4	2.00	17.4	0.95	5.71	0.96	5.77	50	700
	20	3/4	26.9	2.35	22.2	1.41	8.46	1.42	8.52	50	700
	25	1	33.8	2.65	28.5	2.01	12.06	2.03	12.18	50	700
	32	1-1/4	42.5	2.65	37.2	2.58	15.48	2.61	15.66	50	700
	40	1-1/2	48.4	2.90	42.6	3.25	19.50	3.29	19.74	50	700
	50	2	60.2	2.90	54.4	4.11	24.66	4.18	25.08	50	700
	65	2-1/2	76.0	3.25	69.5	5.80	34.80	5.92	35.52	50	700
	80	3	88.7	3.25	82.2	6.81	40.86	6.98	41.88	50	700
Medium "B"	90	3-1/2	101.1	3.65	93.8	8.75	52.50	8.93	53.57	50	700
	100	4	113.9	3.65	106.6	9.89	59.34	10.20	61.20	50	700
	15	1/2	21.7	2.65	16.4	1.22	7.32	1.23	7.38	50	700
	20	3/4	27.2	2.65	21.9	1.58	9.48	1.59	9.54	50	700
	25	1	34.2	3.25	27.7	2.44	14.64	2.46	14.76	50	700
	32	1-1/4	42.9	3.25	36.4	3.14	18.84	3.17	19.02	50	700
	40	1-1/2	48.8	3.25	42.3	3.61	21.66	3.65	21.90	50	700
	50	2	60.8	3.65	53.5	5.10	30.60	5.17	31.02	50	700
	65	2-1/2	76.6	3.65	69.3	6.51	39.06	6.63	39.78	50	700
	80	3	89.5	4.05	81.4	8.47	50.82	8.64	51.84	50	700
	100	4	114.9	4.50	105.9	12.10	72.60	12.4	74.40	50	700
	125	5	140.6	4.85	130.9	16.20	97.20	16.7	100.20	50	700
	150	6	166.1	4.85	156.4	19.20	115.20	19.8	118.80	50	700
	200	8	216.3	5.80	204.7	30.10	180.60	--	--	50	700
	250	10	267.4	6.60	254.2	42.40	254.40	--	--	50	700
Heavy "C"	300	12	318.5	6.90	304.7	53.00	318.00	--	--	50	700
	350	14	355.6	7.90	339.8	67.70	406.20	--	--	50	700
	400	16	406.4	7.90	390.6	77.53	465.20	--	--	50	700
	450	18	457.2	7.90	441.4	87.36	524.13	--	--	50	700
	500	20	508.0	7.90	492.2	97.33	583.96	--	--	50	700
	15	1/2	21.7	3.25	15.2	1.45	8.70	1.46	8.76	50	700
	20	3/4	27.2	3.25	20.7	1.90	11.40	1.91	11.46	50	700
	25	1	34.2	4.05	26.1	2.97	17.82	2.99	17.94	50	700
	32	1-1/4	42.9	4.05	34.8	3.84	23.04	3.87	23.22	50	700
	40	1-1/2	48.8	4.05	40.7	4.43	26.58	4.47	26.82	50	700
	50	2	60.8	4.50	51.8	6.17	37.02	6.24	37.44	50	700
	65	2-1/2	76.6	4.50	67.6	7.90	47.40	8.02	48.12	50	700
	80	3	89.5	4.85	79.8	10.10	60.60	10.3	61.80	50	700
	100	4	114.9	5.40	104.1	14.40	86.40	14.7	88.20	50	700
	125	5	140.6	5.40	129.8	17.80	106.80	18.3	109.80	50	700
	150	6	166.1	5.40	155.3	21.20	127.20	21.8	130.80	50	700

Tolerance for Thickness: Light Tubes = -8%
Medium & Heavy Tubes = -10%